

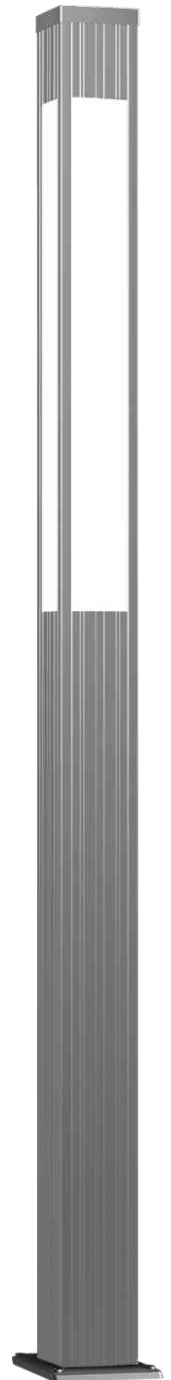

HA0004AL, 250*250mm column
HA0004A, 200*200mm column

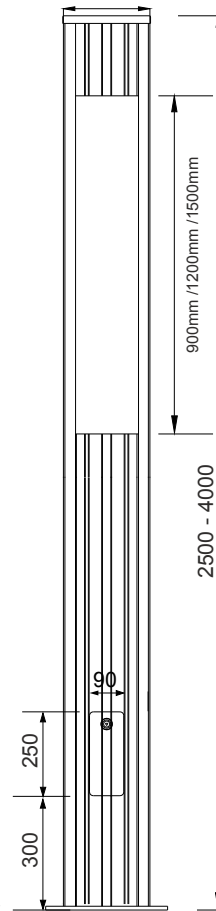

Specifications

Application: Urban roads and street , Squares areas, Pedestrian areas, Residential areas, Parks

Installing Hight: 3-5m

Lamps: LED tube or Fluorescent lamp, 30w-150w

Lamp Wattage: 2.5m pole: 900mm light , 3*10w T5 led or 3*21w T5 FL
3.0m pole: 1200mm light , 3*14w T5 led or 3*28w T5 FL
3.5m pole: 1200mm light , 3*14w T5 led or 3*28w T5 FL
4.0m pole: 1500mm light, 3*17w T5 led or 3*35w T5 FL

Input Voltage: 220-240V/50Hz, 110-130V/60Hz

Material: Aluminium body

Lighting Column: Four piece extrude aluminium assembled square column (stripe surface), four aluminium bar supporting lampshade, powder coating Lens: Opal acrylic lampshade,

Color: Standard color are Black, Dark grey RAL7016 or Light grey RAL 7042 ,other colors are available

Standards:

Isolation degree Class I, IP Rating IP54

200*200mm column
300

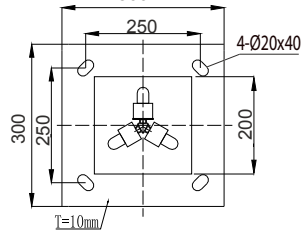

250*250mm column
350

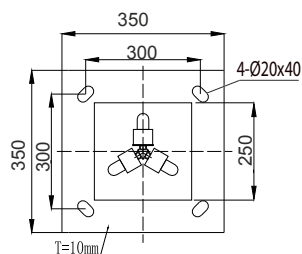

Ordering Information

Order No.	Lamp Wattage	Lamp Socket	Install Height	Gross/ Net Weight	Dimension L*W*H(cm)	Packing size(cm)	QTY(pcs) 20'/40'GP
HA0004A-2.5	T5,LED or FL	G5	2.5m	16/15kg	20x20x250	22x22x250	160/320
HA0004A-3.0	T5,LED or FL	G5	3.0m	19/18kg	20x20x300	22x22x300	80/240
HA0004A-3.5	T5,LED or FL	G5	3.5m	22/21kg	20x20x350	22x22x350	80/240
HA0004AL-3.5	T5,LED or FL	G5	3.5m	29/28kg	25x25x350	28x28x350	50/150
HA0004AL-4.0	T5,LED or FL	G5	4.0m	33/32kg	25x25x400	28x28x400	50/100