

HA0002A

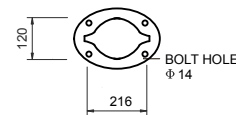
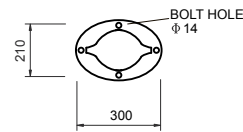

Specifications

Application: Squares areas, Pedestrian areas, Residential areas, Parks, Walkways, Pathway, Driveway, Entrance

Installing Hight: 2-3m

Lamps: LED tube or Fluorescent lamp, 20w-60w

Lamp Wattage: 2.5m pole: 900mm light , 2*10w T5 led or 2*21w T5 FL
 3.0m pole: 1200mm light , 2*14w T5 led or 2*28w T5 FL
 Corners of two side can be installed led strip

Input Voltage: 220-240V/50Hz, 110-130V/60Hz

Material: Aluminium body

Lighting Column: Four pieces extrude aluminium, Polyester powder coating

Lens: Opal acrylic /PC lampshade

Color: Standard color are Black, Dark grey RAL7016 or

Light grey RAL 7042 , other colors are available

Standards:

Isolation degree Class I, IP Rating IP54

Ordering Information

Order No.	Lamp Wattage	Lamp Socket	Install Height	Gross/ Net Weight	Dimension L*W*H(cm)	Packing size(cm)	QTY(pcs) 20'/40'GP
HA0002A-2.5	T5, LED or FL	G5	2.5m	19/18kg	25x16x250	27x18x250	160/320
HA0002A-3.0	T5, LED or FL	G5	3.0m	23/22kg	25x16x300	27x18x300	80/240